

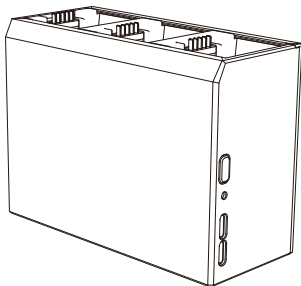

# Battery Charging Hub

## User Guide

V1.0



+1(833)766-4733  
usa@holystone.com (USA)  
eu@holystone.com (EU)

www.holystone.com  
ca@holystone.com (CA)  
au@holystone.com(AU)



- Please read this document in its entirety and all safe and legal practices before use.
  - Place the charging hub on a flat, stable surface when in use. Ensure that the unit is well insulated to prevent a fire hazard.
  - DO NOT attempt to touch the metal terminals on the hub. Clean the metal terminals with a clean, dry cloth if there is any noticeable buildup.
- 

## Diagram

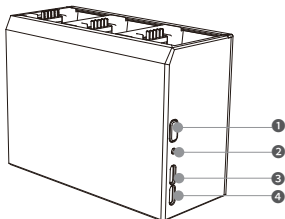

❶ Mode Button

❷ Status LED

❸ Input (USB-C Port, 5-12V, Max. 2A, Supports QC & PD)

❹ Output (USB-C Port, 5V 1A)

## Usage

The battery charging hub can charge and store the drone battery for maintenance, and can also charge external devices such as remote control or cell phone. It is divided into the following three functions.

### Charging Intelligent Flight Battery

1. As shown in Figure (1)-a, Insert the batteries into the charging hub.
2. Use the Type-C charging cable and charger to connect to the AC power supply (100-240V, 50/60 Hz). When charging, the status LED is red and flashing slowly. The charging hub can only charge the batteries one by one according to the order of high to low power (after one is full, it will automatically switch to the other one until all the batteries are full). The battery lights indicate the battery level during charging. Remove the batteries from the Charging hub according to Figure (1)-b. (When using the hub to charge the battery, charging through the battery's USB-C port is not allowed.)

### Using Charging Hub as a Power Bank

1. As shown in the Figure (2), Insert the battery, and connect the external device to the output port.
2. Turn on the drone battery power.
3. Press the mode button once, then the status LED of the charging hub turns blue and flashing slowly. The drone battery will be discharged according to the order of the power level from low to high. If the remaining charge of a battery is low, the battery cannot charge the external device. Press the mode button once again to exit external discharge. (Some devices with special internal programs may not be rechargeable.)

### Accumulating Power

1. As shown in the Figure (3), Insert more than one battery into the charging hub.
2. Turn on the drone battery power.
3. Press and hold the mode button until the status LED of the charging hub turns red, and the charge is transferred from the battery with the lowest power level to the battery with the highest power level. When the receiving battery is fully charged or the power of output battery is low, the power accumulation will stop. After accumulating power, charge the battery with the lowest power level as soon as possible to avoid discharge. Press the mode button once to exit this mode.

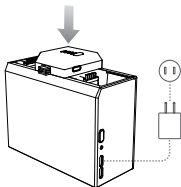

(1)-a

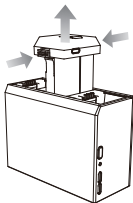

(1)-b

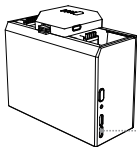

(2)



(3)

## Specifications

Size	116x51x85mm
Net weight	117g
Input(USB-C)	5-12V, Max. 2A (Support QC & PD)
Output(USB-C)	5V/1A
Charging time	About 110 minutes per battery (Shortest)