

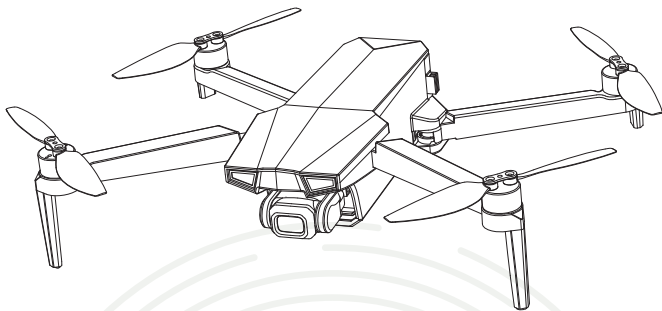

# Quick Start Guide V 1.0

## HS790



+1(833)766-4733    usa@holystone.com (USA)    ca@holystone.com (CA)  
www.holystone.com    eu@holystone.com (EU)    au@holystone.com (AU)



**... download the  
HS GPS V5 APP**

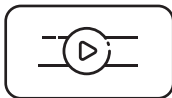

**... watch the  
Tutorial Video**



**... view the Instru-  
ctions For Use**

# DIAGRAM OF THE DRONE

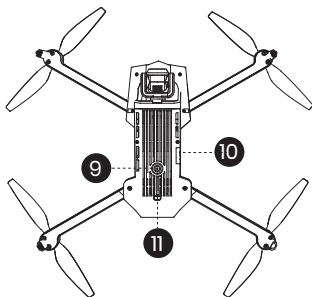
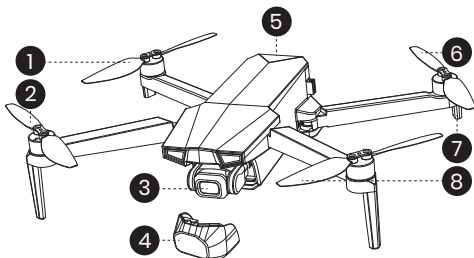

- |  |                        |
|--|------------------------|
| <b>1</b> Propeller A                   | <b>2</b> Propeller B   |
| <b>3</b> Gimbal and Camera             | <b>4</b> Gimbal Cover  |
| <b>5</b> Drone Battery                 | <b>6</b> Propeller B   |
| <b>7</b> Drone Status Indicators       | <b>8</b> Propeller A   |
| <b>9</b> Optical Flow Positioning Lens | <b>10</b> TF Card Slot |
| <b>11</b> TOF Ranging Sensor           |                        |

# DIAGRAM OF THE TRANSMITTER

## • Front:

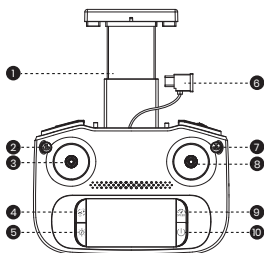

## • Top:

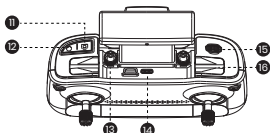

## • Right:

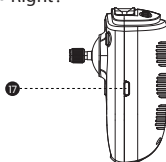

- |  |   |
|--|---|
| <b>1</b> Phone Holder                        | <b>2</b> Takeoff/Landing: short press                         |
| <b>3</b> Left Joystick                       | <b>4</b> GPS Switch: short press<br>Headless Mode: long press |
| <b>5</b> Compass Calibration:<br>long press  | <b>6</b> Connection Cable                                     |
| <b>7</b> Return to Home(RTH):<br>short press | <b>8</b> Right Joystick                                       |
| <b>9</b> Speed Switch: short press           | <b>10</b> Power Switch: long press                            |
| <b>11</b> Take Photo: short press            | <b>12</b> Record Video: short press                           |
| <b>13</b> Storage Slots for Joysticks        | <b>14</b> Connection Port                                     |
| <b>15</b> Gimbal Dial                        | <b>16</b> Cellphone Slot                                      |
| <b>17</b> Charging port(Type-C)              |   |

# 1 CHARGING

Attach the USB charging cable to a USB Adapter, then link it with the charging port of the drone battery or transmitter.

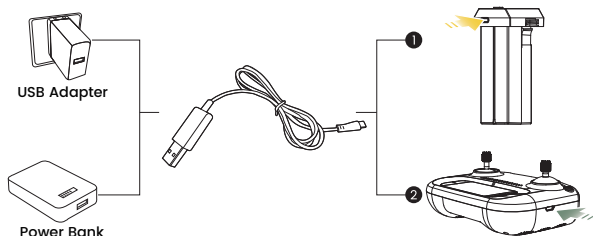

# 2 GET THE DRONE READY

1

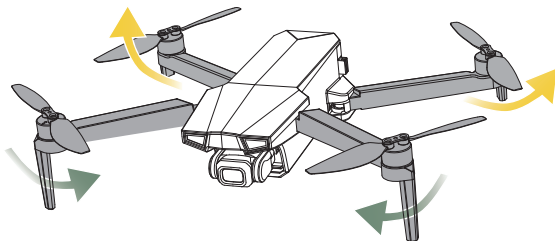

2

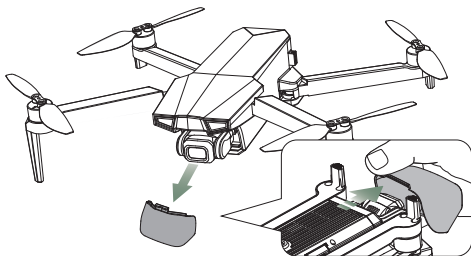

3

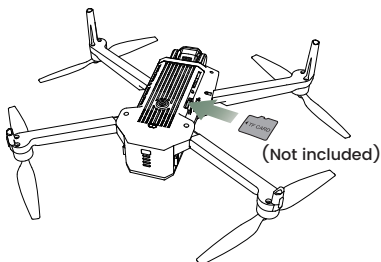

4

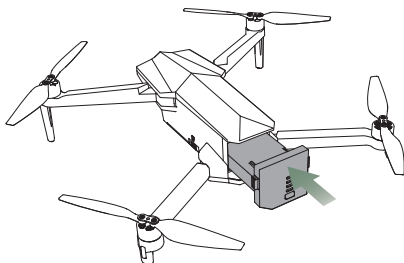

Check the battery to ensure it is securely installed.



## GET THE TRANSMITTER READY

1

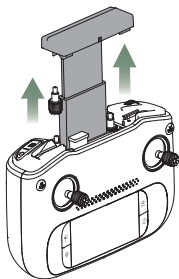

2

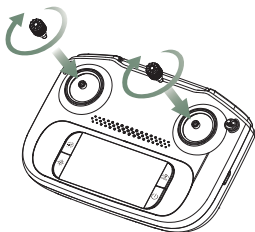

3

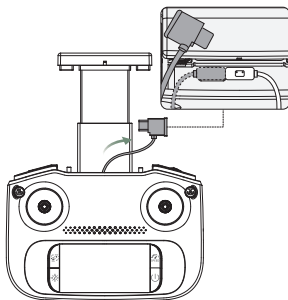

4

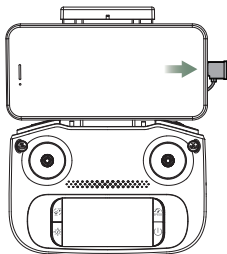

# 4 PAIRING

1

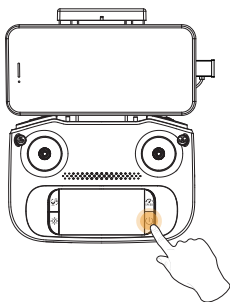

2

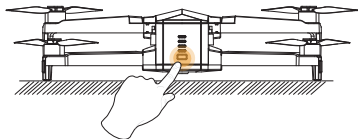

3

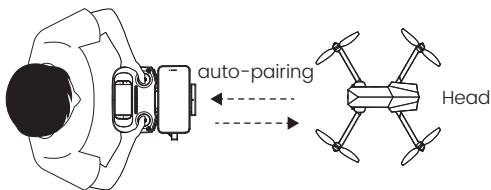

 The transmitter sends out a long beep when the pairing is done.



# 5

## RUN THE APP

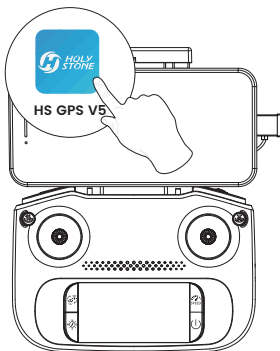

# 6

## CALIBRATE THE COMPASS

1

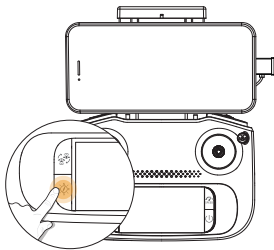

2

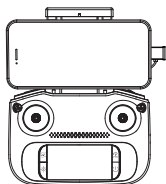
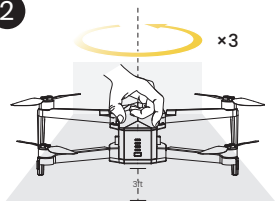

3

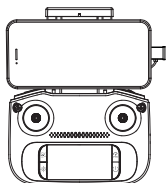
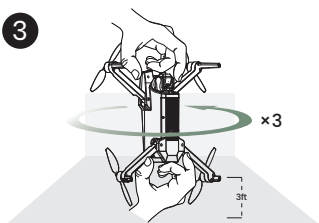

# 7

## CALIBRATE THE GYRO



Be sure to perform gyro calibration on a level surface.

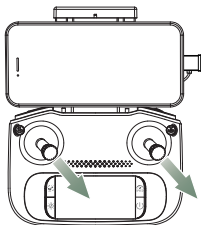

# 8

## UNLOCK THE MOTORS

 Please make sure that you only unlock and control the drone when the drone successfully finds satellites and the app indicates "ready to fly" .

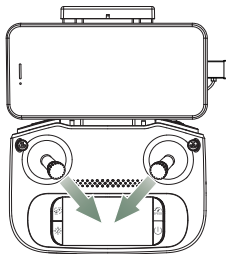

# 9

## TAKE-OFF

 Please fly the drone in an open outdoor area free of surrounding obstructions.

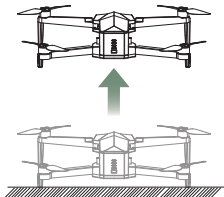
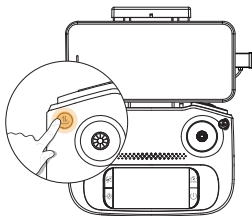

# 10

## FLIGHT DIRECTION CONTROL

The left joystick is responsible for controlling the drone's height and orientation in flight, whereas the right joystick dictates the movements in forward, backward, and lateral directions.

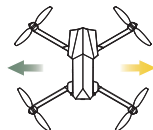
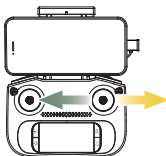
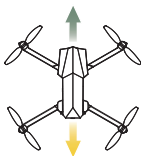
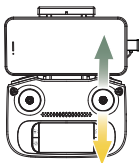
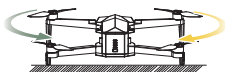
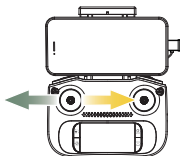
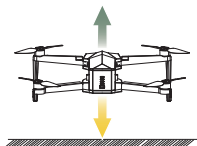
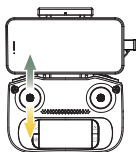

# 11

## LANDING

